

Multilingual Version

[English](#)

[中文](#)

■ CAMERA INSTALLATION



▼ Standard package

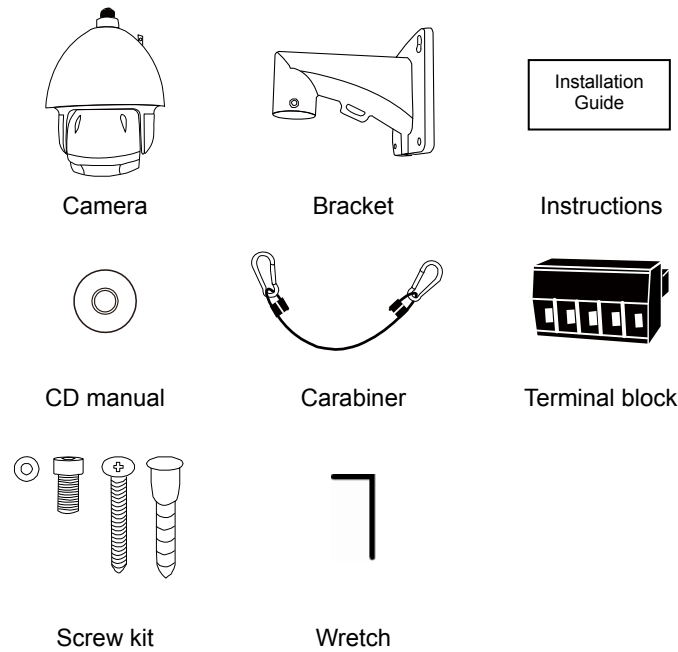

▼ For selected models only



Waterproof kit

Step 1: Locate to where you want to install this camera and drill 4 holes for bracket installation. (Figure 1)

NOTE: Drill one hole for the cable to go through if necessary.

Step 2: (Optional) Insert a microSD card for local recording.

NOTE: To know how to install a microSD card, please check the section, "INSERT A MICRO SD CARD".

Step 3: Pass the cables to be connected through the bracket, and fasten the bracket to the wall (Figure 2)

Step 4: Hook the camera and the bracket together with the supplied carabiner, and connect the cables. Then, pull the cables from the other side of the bracket to hide the connectors in the bracket. (Figure 3)

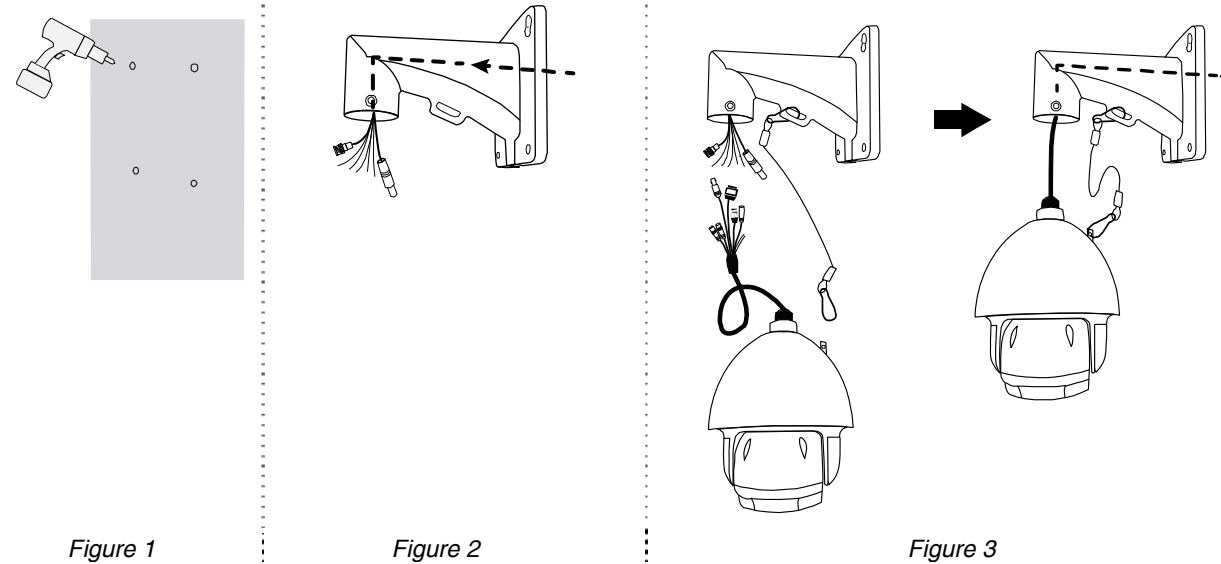

Step 5: Secure the bracket onto the wall with the supplied screws. (Figure 4)

NOTE: You might need another hand to hold the camera in this step.

Step 6: Insert the camera to the bracket. Then, use the supplied wrench and screws to fasten the bracket and the camera. (Figure 5)

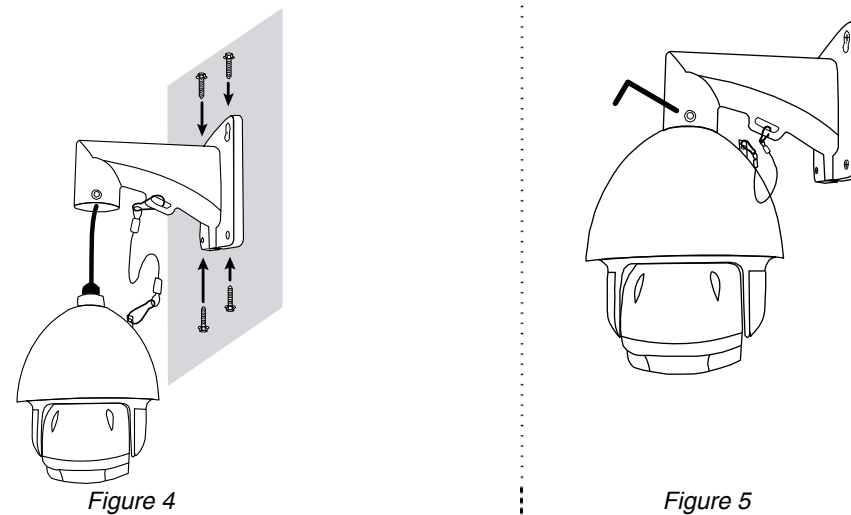

■ CABLE OVERVIEW

Cable	Description
Power cable	Connect to the supplied adapter.
RJ45 network cable*	Connect to an Ethernet network cable.
BNC cable	No function.
Terminal block	
1. ALARM IN	Alarm input for an alarm device like magnetic contacts.
2. ALARM OUT	Alarm output for an alarm device like a siren.
3. GND	Ground wire
4. RS485_A	Used for PTZ camera or other device connection.
5. RS485_B	Used for PTZ camera or other device connection.
Line-in	Colored as blue, used to connect to a microphone for audio input.
Line-out	Colored as green, used to connect to a speaker for audio output.
RESET	A wire reserved for hardware reset.
GND	Remove the insulating coating of the wire, and twist it with the GND wire together to reset the camera to its factory values.

* For PoE (IEEE802.3af) installation, make sure your network cable has the maximum cable resistance of 20Ω , such as CAT.5e or CAT.6 cables, to conform to the standard of IEEE802.3af.

■ INSERT A MICRO SD CARD

The data originally saved in the microSD card (if any) will be removed after inserting it to the camera.

The camera doesn't support hot-swapping. Please insert or remove the microSD card with power disconnected.

Step 1: Remove the four screws. Then remove the plastic hull.

Step 2: After opening the camera hull, you can see the inner structure. As the below illustration shows, insert the SD card face down into the slot.

Step 3: Replace the hull back, and make sure it's fastened tightly to ensure the waterproof function works properly.

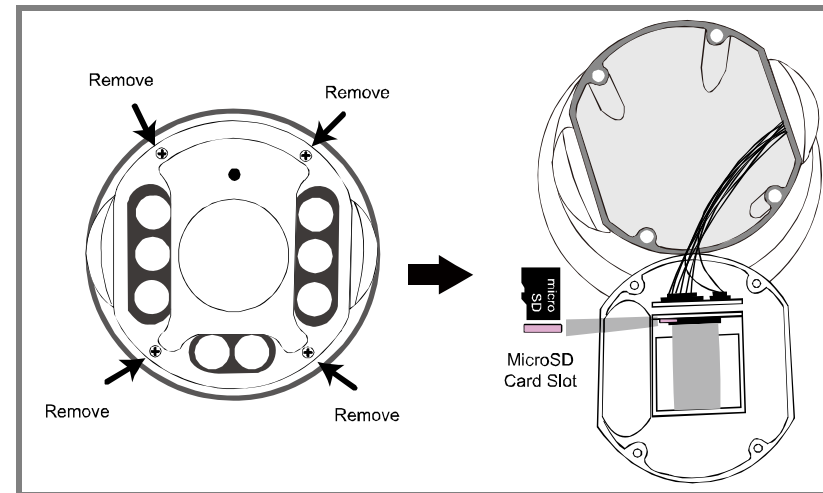

■ DEFAULT VALUES

IP address	192.168.1.10
Port number	88
User name	admin
Password	admin

It's strongly recommended to change the default user name and password before using the camera to keep your account safe.

To change the default account, log into the camera, and go to **Config.** → **General** → **Account**. Create a new account, and remove the default one.

■ WATERPROOF KIT FOR NETWORK CABLE (Optional)

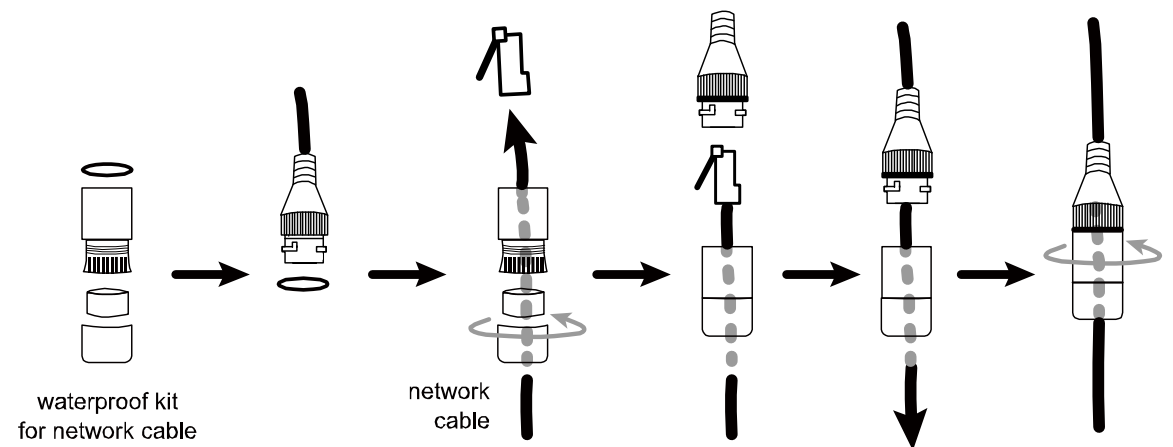

■ SET CAMERA ID AND BAUD RATE

Before connecting this camera to other brand's NVR, you may need to manually set the ID & baud rate for the camera to work properly. Please check the description below for details.

Note: The on / off of the DIP switch is shown as white.

■ Where to set

Remove the panel as indicated below to find the dip switch.

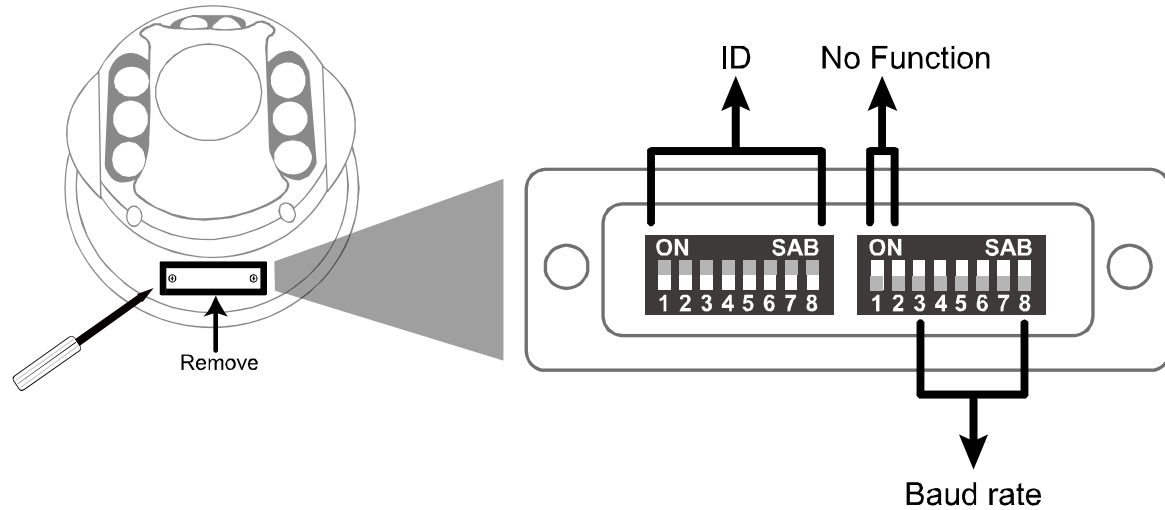

■ ID

The ID number can be set from 0~255 (binary). Please check the examples below.

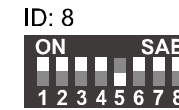
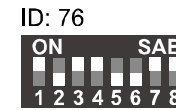
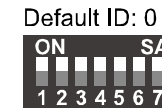

■ Baud Rate

2400



4800



9600



19200

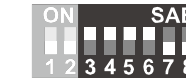

38400



■ SYSTEM CONNECTION

1. Connect IP cameras and a monitor to the NVR, and power on the NVR, as illustrated below.

Note: Local connection only allows monitoring locally. To monitor from anywhere other than the NVR is installed, please connect your NVR to Internet.

2. Wait till each camera is configured automatically and you will see camera images on the monitor soon.

Note: Local connection only allows monitoring locally. To monitor from anywhere other than the NVR is installed, please connect your NVR to Internet.

Type1

Connect IP cameras
(as many as the NVR supports):

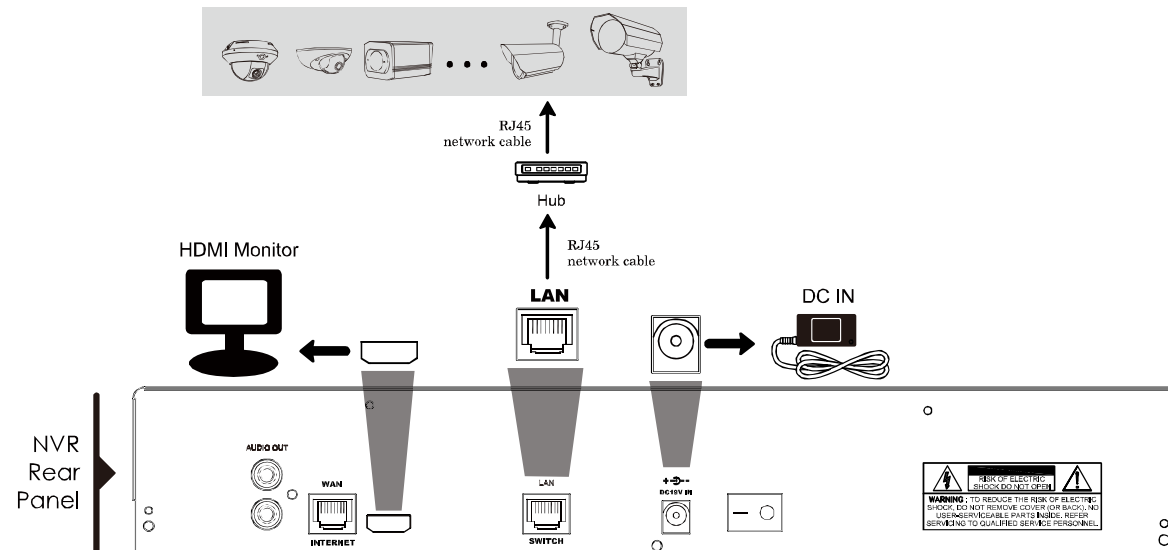

Type2

Connect IP cameras
(as many as the NVR supports):

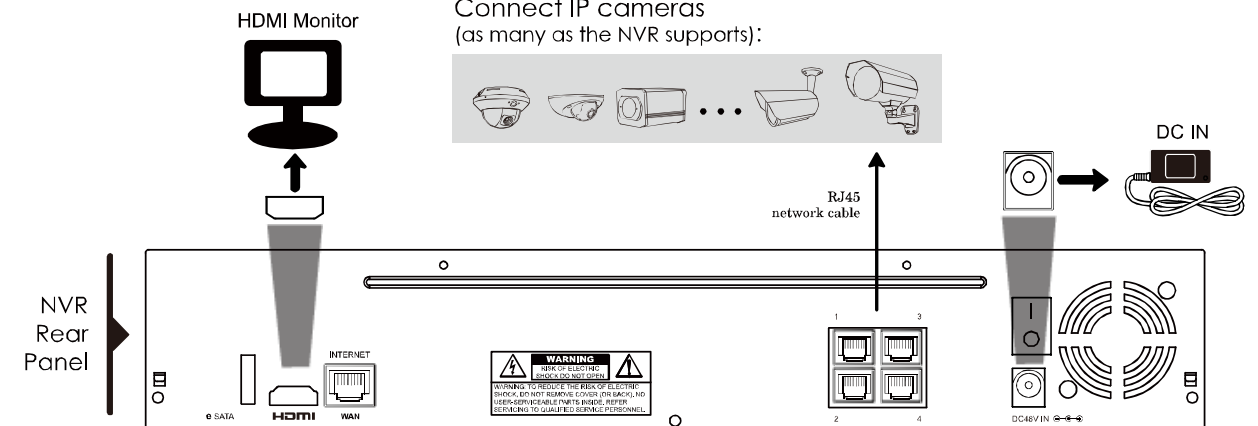

■ 安裝指南

取得完整使用者指南，請造訪 www.surveillance-download.com/user/m2592.swf，或掃描右方 QR code。

取得免費電腦版 CMS 軟體 (CMS Lite)，請讀取附件 CD 或前往 www.surveillance-download.com/user/m2592.swf。



▼ 標準配件

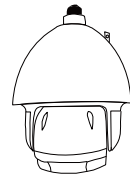

攝影機

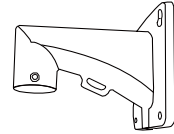

支架

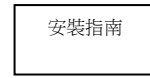

安裝指南



CD

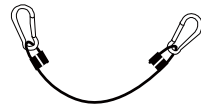

安全勾

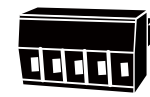

端子台

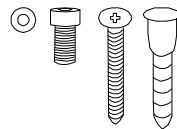

螺絲套件



扳手

▼ 僅提供於特定型號



防水套件

步驟 1: 在攝影機安裝位置鑽四個相對應地孔位 (圖 1)。

註: 若需要將線材穿牆安裝，請多鑽一個孔。

步驟 2: (需要時) 安裝 microSD 卡供本機端錄影。

註: 相關安裝步驟請詳閱「安裝 microSD 卡」部分。

步驟 3: 先將線材穿入攝影機，再將支架鎖上牆。(圖 2)

步驟 4: 以安全勾兩端連接攝影機與支架，一手托起攝影機，一手輕輕將線材拉入牆後，整線，將多餘長度收納進支架內。(圖 3)



圖 1



圖 2

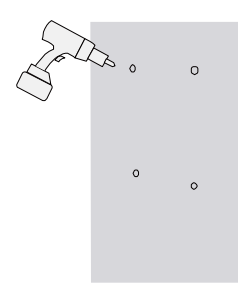

圖 3

步驟 5: 利用配件螺絲將支架鎖上牆(圖 4)

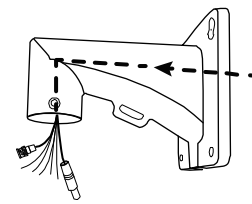
註: 請托住攝影機，方便安裝。

步驟 6: 最後，使用配件扳手及螺絲將攝影機與支架固定。(圖 5)

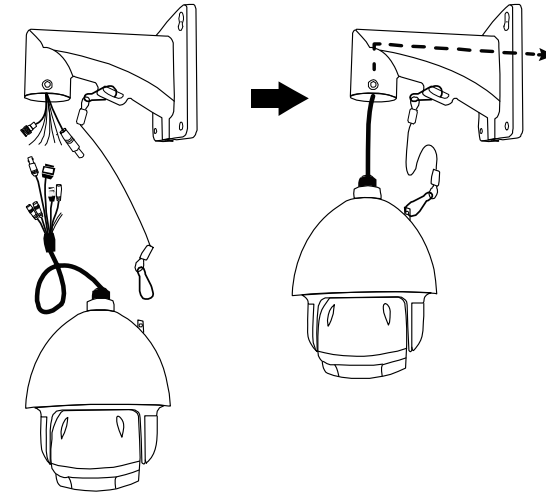

圖 4



圖 5

■ 線材

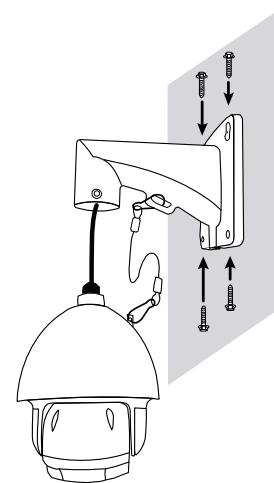
線材	說明
電源線	連接變壓器
RJ45 網路線*	與乙太網路線連接
BNC	無特殊功能
端子台	
1. ALARM IN	警報輸入接孔，用來連接如磁簧開關的警報裝置。
2. ALARM OUT	警報輸出接孔，用來連接如蜂鳴器的警報裝置
3. GND	地線
4. RS485_A	連接 PTZ 攝影機或其他裝置
5. RS485_B	連接 PTZ 攝影機或其他裝置
Line-in	藍線，連接麥克風收音。
Line-out	綠線，連接擴音器擴音。
RESET	可用來重設硬體回覆原廠設定值。撥開線材外層露出線芯，然後將這兩條線的線芯擰繞在一起，就可將攝影機重設為出廠設定值。
GND	

* * PoE (IEEE802.3af) 安裝，使用的網路線電阻須達 20Ω，可用 CAT.5e 或 CAT.6 線材。

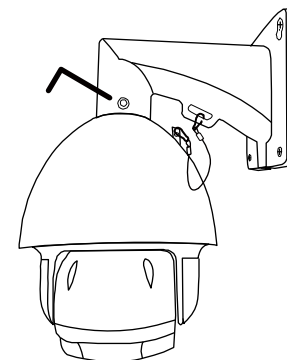
■ 安裝 MICRO SD 卡

插入攝影機後，micro SD 卡內的舊資料會自動刪除。

插入或取出 micro SD 卡時請務必拔除電源。

步驟 1: 使用螺絲起子取下螺絲，打開攝影機前蓋。

步驟 2: 內部構造如下圖所示，請將 micro SD 卡面下插入機內。

步驟 3: 鎖回前蓋。請務必鎖緊以免防水功能打折扣。

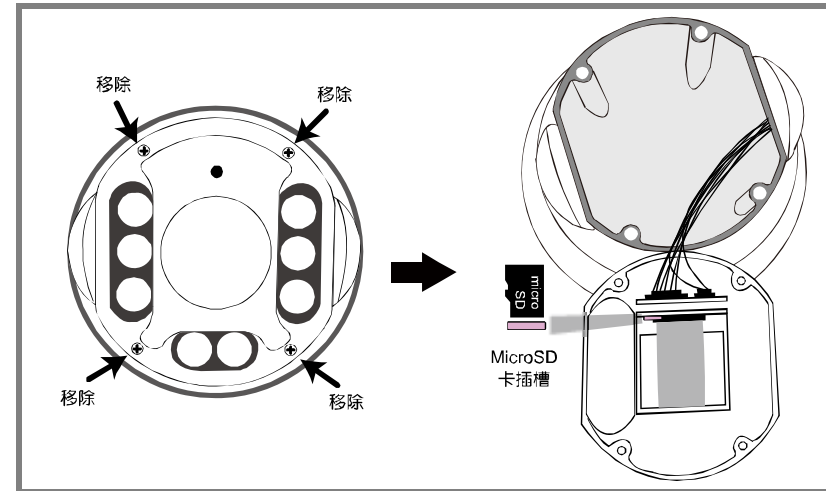

■ 出廠設定

IP 位置	192.168.1.10
埠號	88
使用者名稱	admin
密碼	admin

為確保帳號安全，強烈建議您請在操作前重新設定使用者名稱及密碼。

建立新帳號及刪除原始設定：登入攝影機，設定 → 常用設定 → 帳戶設定。

■ 防水套件 (選用配件)

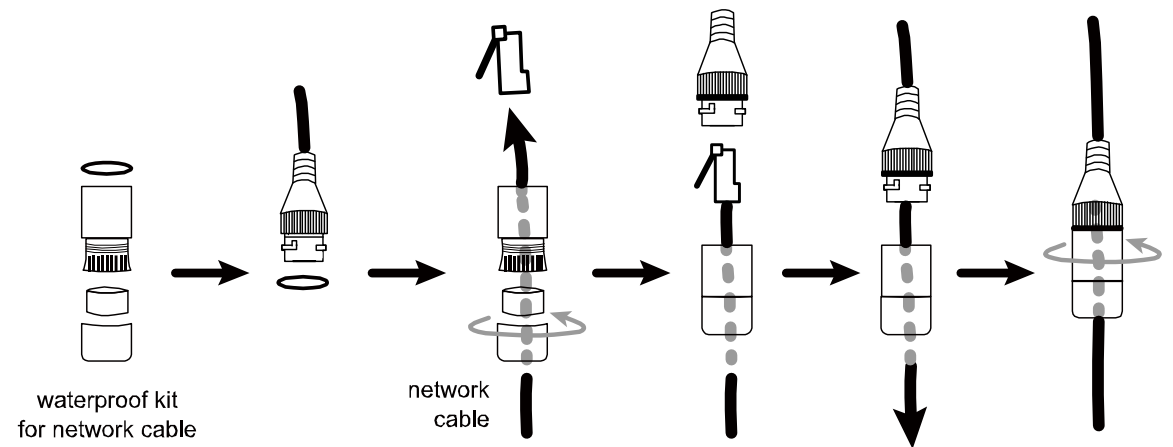

■ 設定攝影機 ID 及鮑率

將本公司攝影機與其他廠牌 NVR 連接使用前，請先進行 ID 及鮑率設定。步驟如下：

註： 灰色表示指撥開關撥向的位置。

■ 操作位置

打開面板，即可看見指撥開關。

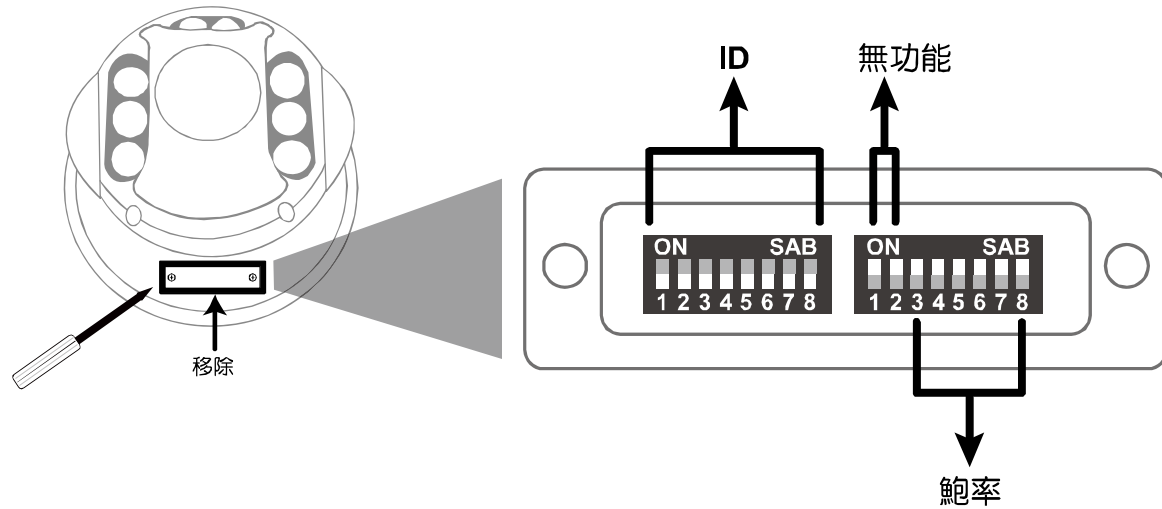

■ ID

設定範圍 0~255 (二進位)

請參考以下示範：

預設 ID : 0



ID: 76



ID: 8



■ Baud Rate

2400



4800



9600



19200



38400



■ 系統架設

1. 將 IP 攝影機與螢幕連接至 NVR，再將 NVR 上電。

註： 本機端連線僅供本機端監視所用。如需遠端監視，請將 NVR 連上網路。

2. 請稍待片刻，待螢幕上出現攝影機圖示，表示自動設定完成。

註： 本機端連線僅供本機端監視所用。如需遠端監視，請將 NVR 連上網路。

型一

Connect IP cameras
(as many as the NVR supports):

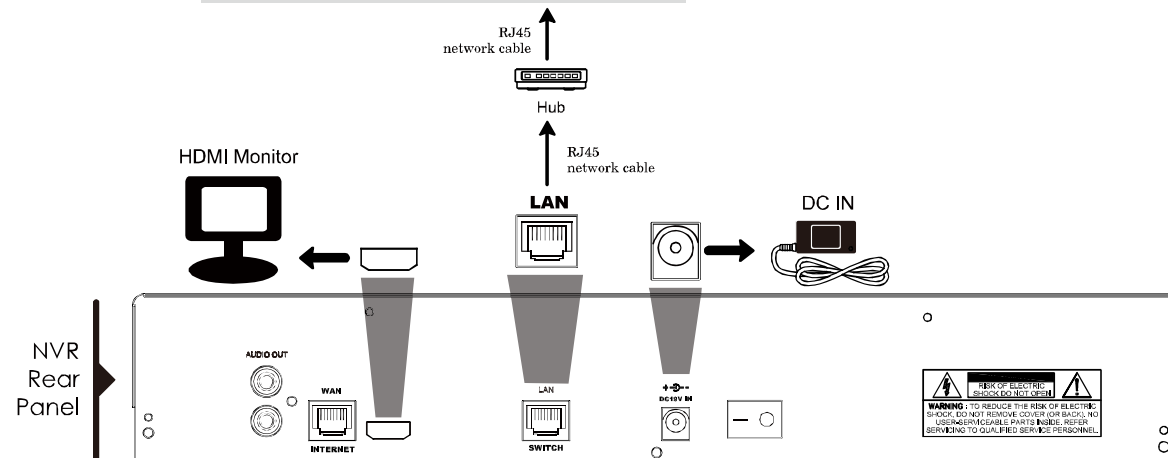

型二

Connect IP cameras
(as many as the NVR supports):

